

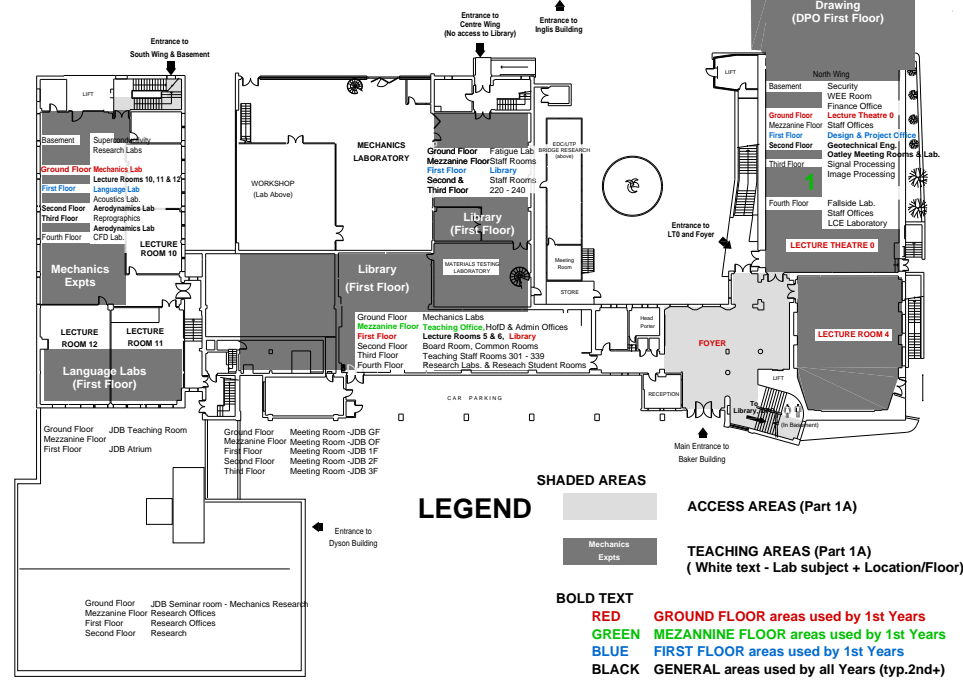

Department of Engineering

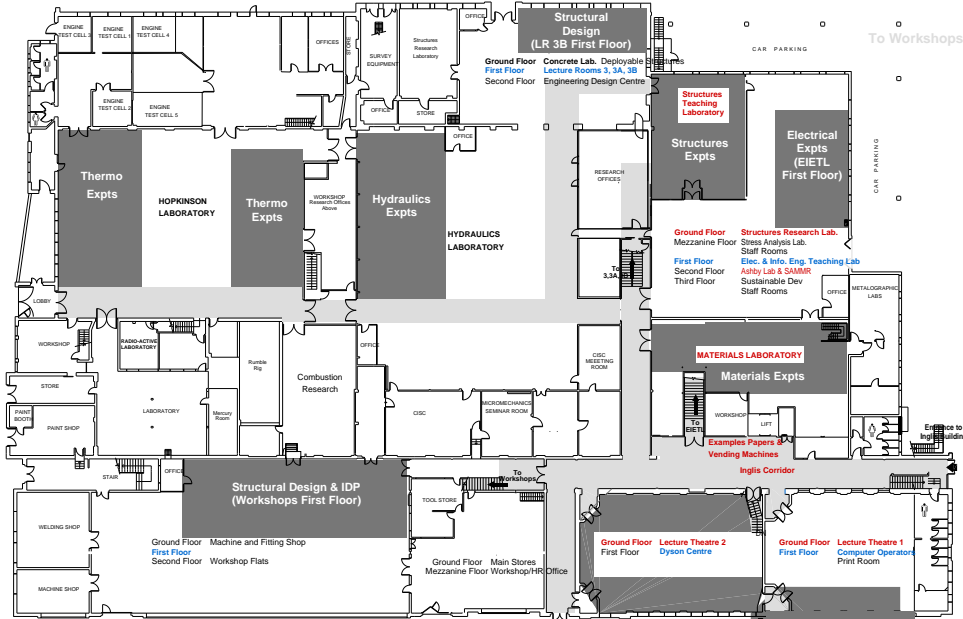

LEGEND

SHADED AREAS



ACCESS AREAS (Part 1A)

TEACHING AREAS (Part 1A)
(White text - Lab subject + Location/Floor)

BOLD TEXT

- RED GROUND FLOOR areas used by 1st Years
- GREEN MEZZANINE FLOOR areas used by 1st Years
- BLUE FIRST FLOOR areas used by 1st Years
- BLACK GENERAL areas used by all Years (typ.2nd+)